

431

Surface-mounted wall louvre

SURFACE-MOUNTED LOUVRE

ALUMINIUM



MATERIAL

- Made from aluminium sections: AlMgSi 0.5 (according to EN 12020-2)
- Stainless steel 304 insect screen (2.3 x 2.3 mm)
- Finishing: anodized in satin colour (20 micron) or powder-coated in any RAL or Syntha Pulvin colour (40 micron)

DIMENSIONS

- Blade pitch: 33 mm
- Thickness: 29 mm
- Minimum dimensions: 120 x 120 mm

FIXING

- Screws and plugs are included
- Louvre 432 is the removable version of louvre 431 (see p. 76)

OPTIONS

- Stainless steel 304 mesh (6x6/10x10/20x20 mm) or without
- Burglar resistance louvre 431RC2 (see p. 126)
- Insect screen or mesh in stainless steel 316

TYPICAL APPLICATIONS

- Fixed louvre
- Nightcooling
- Standard surface-mounted louvre

STOCK MODELS

Dimensions (W x H) mm	Natural colour anodised	Renson Standard WHITE	STR 7016	STR 9005	Airflow at 2 Pa (m³/h)
165 x 165	00431111	00431116	00431113	00431119	29.4
225 x 225	00431122	00431226	00431223	00431229	56.8
325 x 325	00431133	00431336			143
425 x 425	00431144				245
525 x 525	00431155				373

TECHNICAL SPECIFICATIONS

All properties are valid for the standard version of the Louvre, unless otherwise stated.

Airflow		[EN 13030]
K-factor [entry]		26.30
K-factor [discharge]		25.51
C _e coefficient		0.195
C _d coefficient		0.198
Technical data		
Visual free area		59%
Physical free area		45%
IP class [louvre with mesh; electrical installation at least 100 mm from louvre]		IP2XD



Ventilated cooling

TECHNICAL DRAWINGS

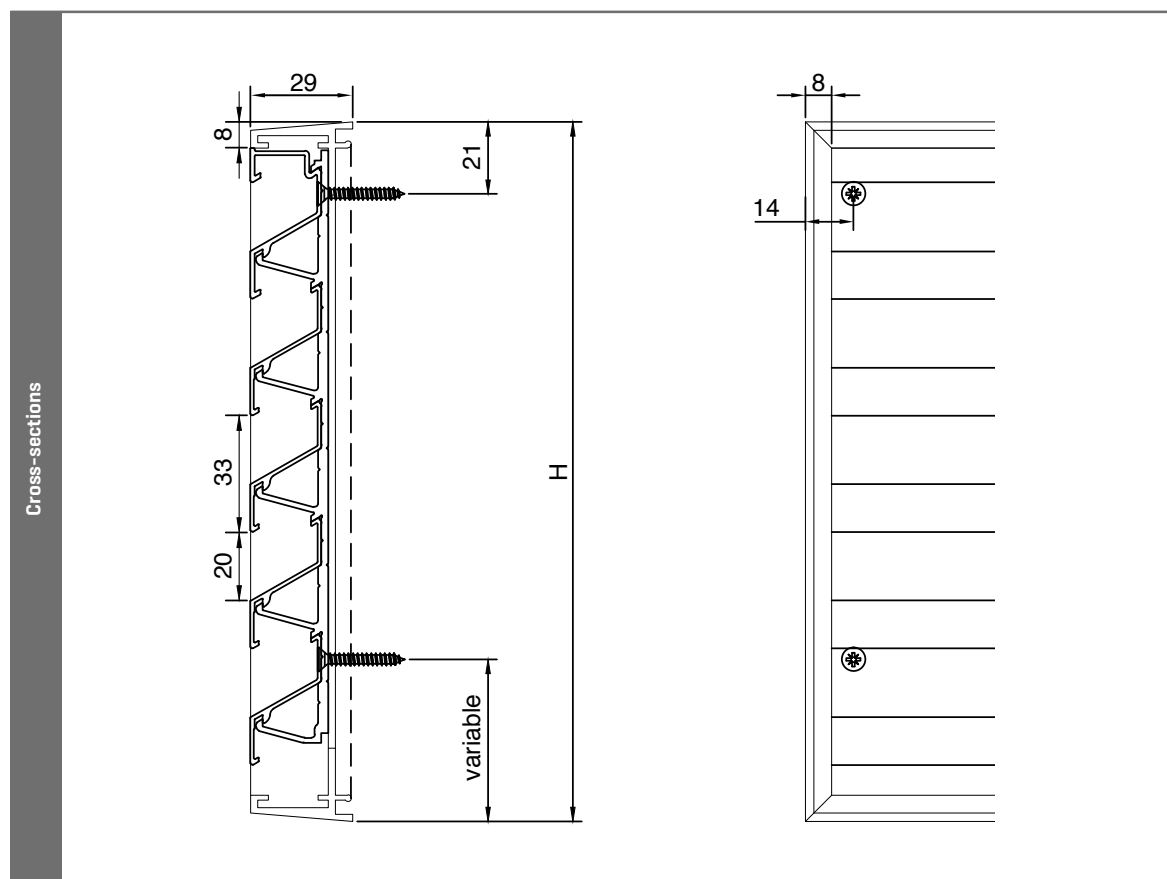

431R

Round louvre without frame

SURFACE-
MOUNTED
LOUVRE

ALUMINIUM

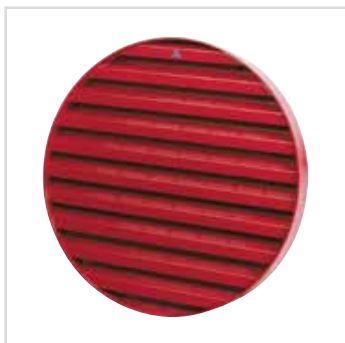

MATERIAL

- Made from aluminium sections: AlMgSi 0.5 (according to EN 12020-2)
- Stainless steel 304 insect screen (2.3 x 2.3 mm)
- Finishing: anodized in satin colour (20 micron) or powder-coated in any RAL or Syntha Pulvin colour (40 micron)

DIMENSIONS

- Blade pitch: 33,3 mm
- Depth to fit: 40 mm
- Minimum diameter: 300 mm
- Maximum diameter:
 - 1400 mm if anodised in satin colour
 - 1500 mm if powder-coated in RAL or Syntha Pulvin colour
 - Over 1500 mm: in two parts

FIXING

- Screws included

OPTIONS

- Stainless steel 304 mesh (6x6/10x10/20x20 mm) or without
- Insect screen or mesh in stainless steel 316

TECHNICAL SPECIFICATIONS

All properties are valid for the standard version of the Louvre, unless otherwise stated.

Airflow		[EN 13030]
K-factor (entry)		23.56
K-factor (discharge)		25.51
C _e coefficient		0.206
C _d coefficient		0.198
Technical data		
Visual free area		59%
Physical free area		40.5%
IP class (louvre with mesh; electrical installation at least 100 mm from louvre)		IP2XD

TECHNICAL DRAWINGS

